

Instruction Manual

- Thank you for purchasing this great product.
- Take a few minutes to read through the manual to ensure proper operation.
- Keep the instruction manual for future reference.

The switch and adapter socket can be found on the rear side of the unit.

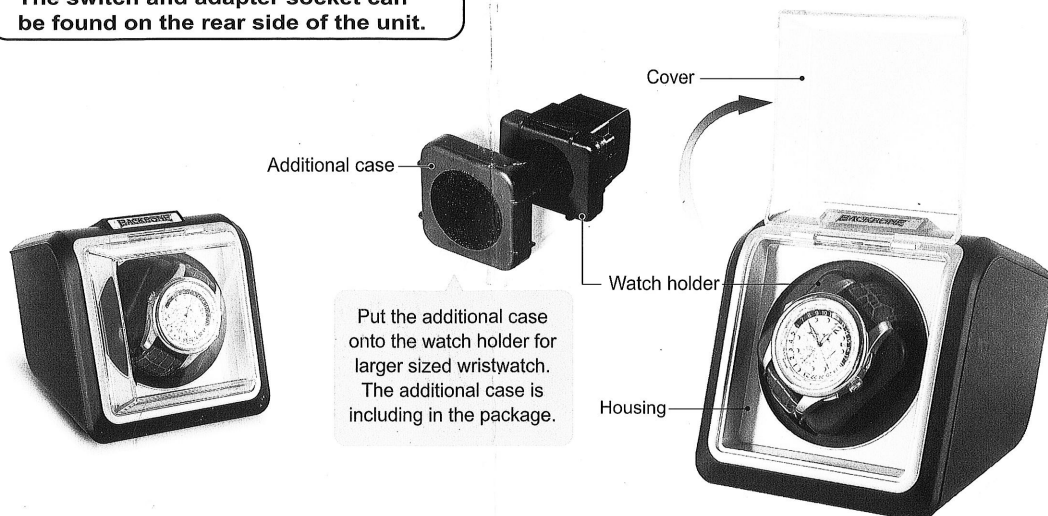

Item Specification

Power	Input: AC/240V,50Hz; Output: DC/3V 200mA
Feature	1. Winds clockwise or counterclockwise by operating the switch. 2. Count down Function: Auto rotate for 1 hour & rest for 3 hours.
Size	120x160x112mm (LxWxH)
Weight	About 350g (without adapter)

Note:

- * Please use the AC adapter DC/3V 200mA supplied with the unit.
- * Remove the adapter when the winder is not in use.
- * Always turn off the power when inserting or removing watches.
- * Don't shake or rotate when winder is stationary.



1. Insert the adapter into the socket located on the back of the winder and plug it into the electrical outlet.
2. Open the cover, then carefully pull out the watch holder.
3. Place the watch around the holder by pushing the spring in the back of the holder, and place your watch around the holder, then let go of the spring.
4. Once the watch is on the holder, place the holder back into the winder. Push until you hear a click signifying that it is securely in the winder.

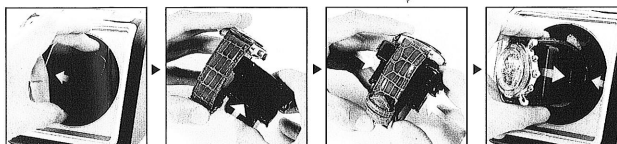

5. Turn the switch [ON].

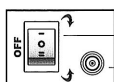

Press to "—" the winder will turn clockwise.

Adapter socket

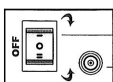

The center position turn the unit off.

Adapter socket

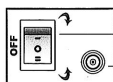

Press to "=" the winder will turn anticlockwise.

Adapter socket

Attention:

- * If you do not use this product for a long time, please take off adapter.
- * Always turn off the power when inserting or removing watches.